

HOW TO INSTALL THIS CYLINDRICAL LEVERSET

● Fit Doors 35mm (1-3/8") to 50mm (2") Thick ● Backset 70 mm (2-3/4")

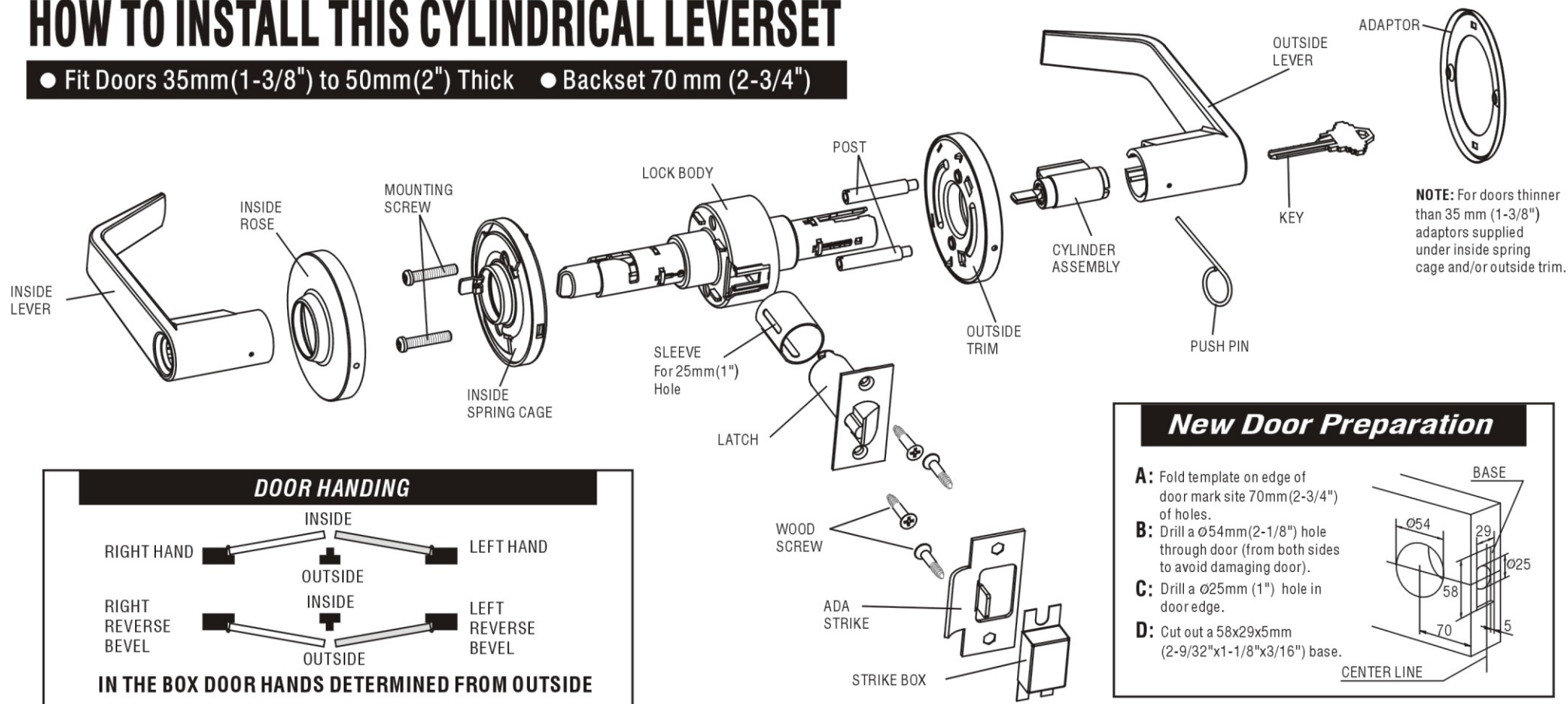

1

DISASSEMBLE INSIDE LEVER AND ROSE

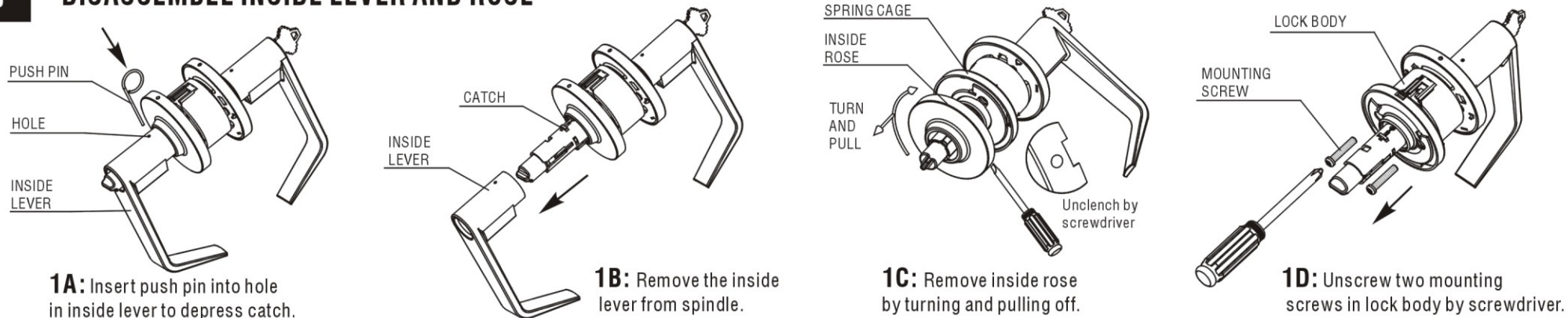

2

ADJUST OUTSIDE TRIM TO SUIT DOOR THICKNESS

[This lock is factory preset for 35mm (1-3/8") doors, if your door thickness is 35~38mm (1-3/8" ~ 1-7/8"), skip Step 2 and go to Step 3 directly.]

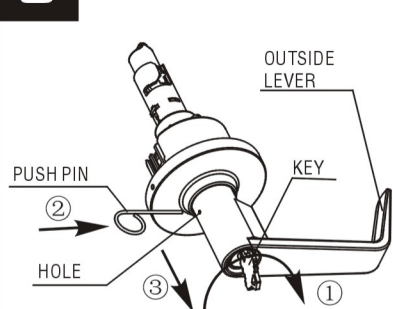

2A: Turn key 75° clockwise, insert push pin into hole in outside lever to depress catch. Remove the outside lever.

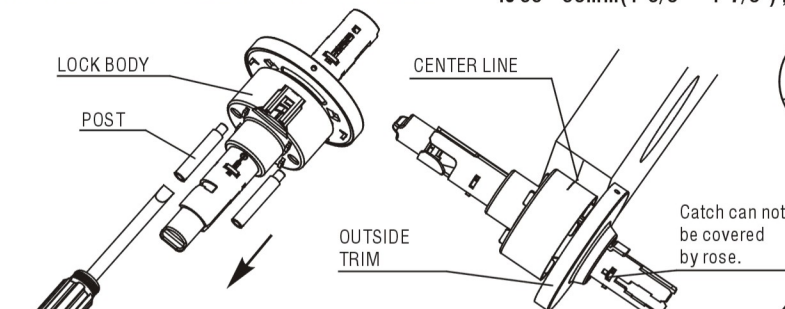

2B: Unscrew two posts in lock body by screwdriver.

2C: Adjust outside trim according to the door thickness, make sure the lock body at both sides is symmetrical.

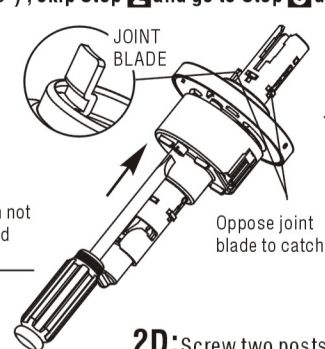

2D: Screw two posts back so as to hold the outside rose tightly.

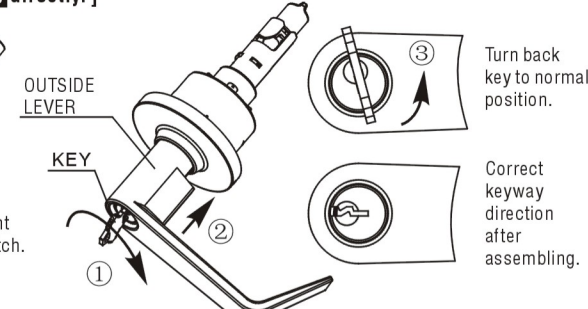

2E: Turn key 90° clockwise and push the lever into the maximum extent; rewind key.

3

INSTALL LEVERSET TO DOOR

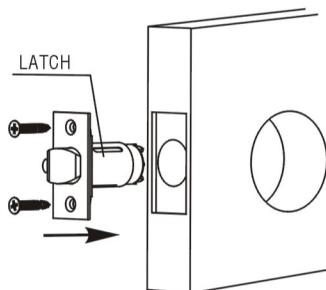

3A: Insert latch unit and fix it with two wood screws.

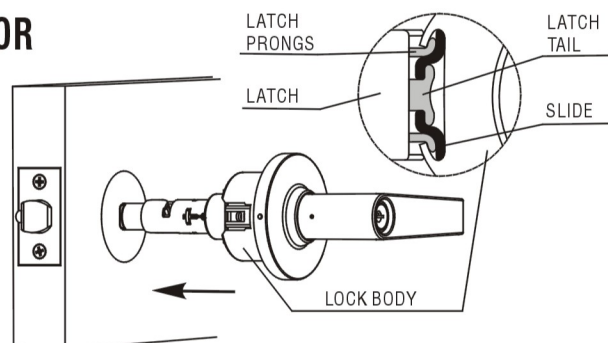

3B: Place lock body into position. Make sure that latch prongs engage chassis in housing, and slide engages latch tail.

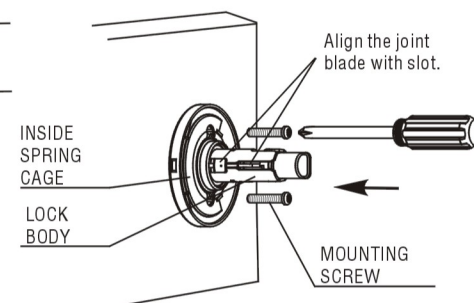

3C: Install inside spring cage, Screws should be tightened to its full length.

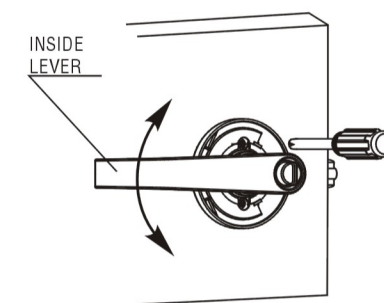

3D: Fix the inside lever and check if the rotation is smooth. Adjust the radial clearance between inside spring cage and inside lever.

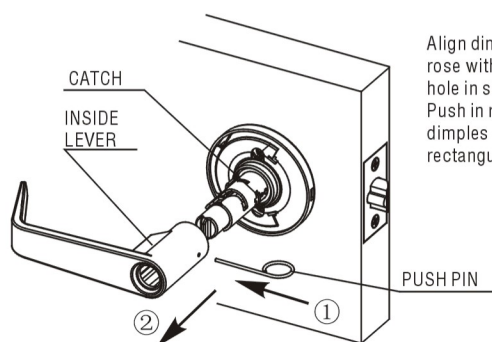

3E: Disassemble inside lever by push pin.

Align dimples on rose with rectangular hole in spring cage. Push in rose until dimples snap into rectangular hole.

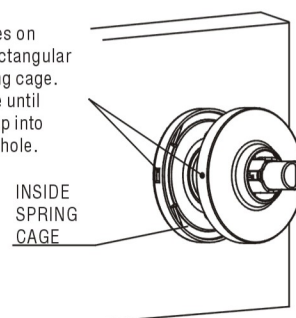

3F: Fix inside rose and make sure inside rose and inside spring cage are tightened.

IMPORTANT
If the door is thicker than 50mm, the catch will be covered by inside rose, do not install inside lever and lock.

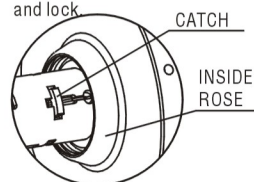

3G: Slide lever onto spindle. Push lever completely into place. (Pull on lever to make sure that catch is fully engaged).

4

INSTALL STRIKE

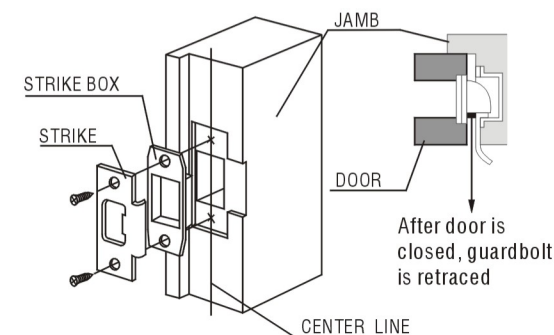

After door is closed, guardbolt is retracted